

Use manual and Warranty

Χρυσή
GAMMAPIÙ





Figura 1



Figura 2

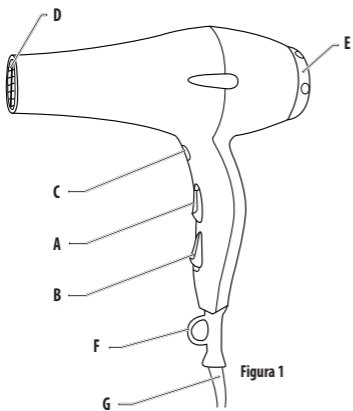

Figura 3

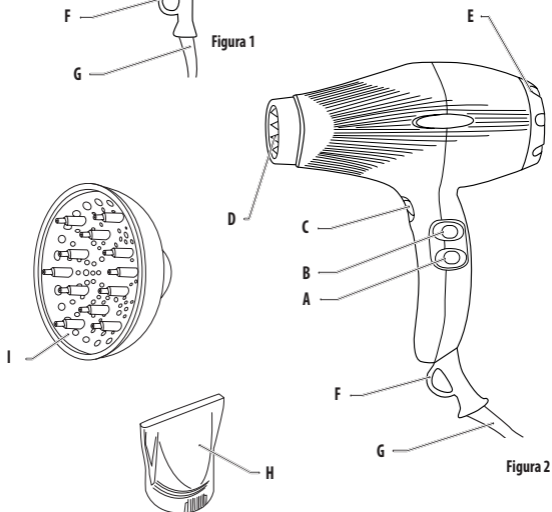

Figura 4

EN - USE MANUAL AND WARRANTY

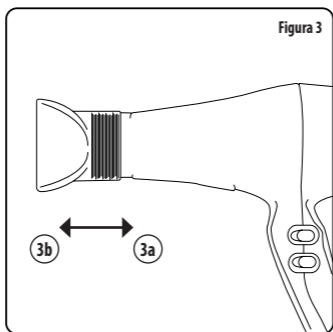
ATTENTION! Equipment for professional use only.

EXPLANATION OF SYMBOLS

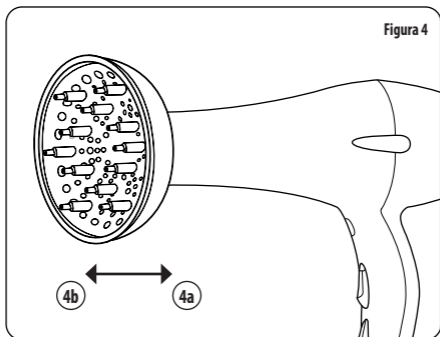

Our products comply with the directives that refer to EC marking.



The class II or Double Insulation symbol indicates that this product is designed so as not to require an earth connection. These products are designed so that a single fault cannot cause the user to come in contact with a hazardous voltage, thanks to the casing being made of insulating material.



This symbol indicates that the product meets the requirements of the new directives introduced so as to protect the environment and must be disposed of appropriately at the end of its life cycle. Request information from the local Authorities about the areas dedicated to waste disposal.



This symbol, generally together with the description, informs the user that there are important operations and instructions to be read.



ATTENTION! HOT SURFACES.
RISK OF BURNS



Do not use this appliance near bathtubs, wash basins or other vessels containing water.

GENERAL SAFETY WARNINGS



To avoid damage and dangers due to improper use, carefully follow the instructions for use and keep them in a safe place. If the product is handed over to a third party also provide the instruction booklet.

UNPACKING AND INSPECTING THE PRODUCT

Remove the product from its packaging and make sure it is intact and has no visible signs of damage caused during transport.

In case of doubt, do not use the appliance and contact the nearest Technical Assistance Centre (see "Technical assistance centres (IT)" specified in this manual).



ATTENTION! DANGER FOR CHILDREN.

The packaging materials (bags made of plastic, polystyrene foam, etc.) must not be left within reach of children as they are potential sources of danger.

ELECTRICAL SAFETY PRECAUTIONS

Using electrical appliances requires compliance with some basic regulations.



Never place the appliance in water or other liquid! Do not touch the appliance if it has fallen into any liquid.



WARNING: do not use this appliance while close to bathtubs, sinks or other containers that hold water!

In particular:

- never touch the appliance with wet or damp hands or feet;
- do not use the appliance with bare feet;
- do not remove the plug from the socket by pulling the power cord or the appliance;
- do not expose the appliance to the elements (rain, sun, etc.);
- do not let children play with the appliance.
- When the appliance is used in a bathroom, unplug it after using it as it can still pose a hazard when switched off and placed near water.
- Always remove the plug from the socket without pulling on the cord.
- Never carry the appliance by its power cord.
- Keep the power cord and the unit away from heated surfaces.
- Do not store or operate the appliance with the cable twisted or bent.
- Do not use the product if the cord or other parts are damaged. If the power cord is damaged it must be replaced by the manufacturer or the relevant technical

assistance or in any case by a person with similar skills in order to prevent any risk.

- Further protection is provided with the integration, in the home electric circuit, of a fault current protection device with a nominal trigger current no greater than 30mA.
- Contact your electrician for further information. The safety of these electrical appliances conforms with known technical rules and with the laws regarding the safety of electrical appliances.
- Do not leave the plug inserted unnecessarily in the socket; unplug the appliance when not in use.
- Place the product on a flat, stable surface, away from sources of heat.
- Noise: The sound pressure level (A-weighted) is less than 70 dB (A).

GENERAL USE WARNINGS

USE

The hair dryer was designed and built for drying and styling human hair.



INCORRECT USE:

Use this appliance only for its intended purpose, do not use with wigs, animal fur or with any material other than human hair. The manufacturer declines all liability concerning misuse of the appliance.



Do not wrap the power cord around the appliance so as to prevent damaging the cord itself and prevent any secondary risk.

Refer to the outer packaging and the specifications on the data plate affixed to the product itself for the relevant technical specifications.

- Make sure that the mains voltage matches the one shown on the technical data plate of the appliance.
- Keep out of reach of children. Children must not use or play with the appliance.
- This appliance can be used by children starting from the age of 8 and by people with reduced physical, sensory or mental capabilities, or by people lacking the experience or knowledge, as long as they are properly supervised and instructed on the use of the appliance and are involved in the comprehension of the dangers.
- Cleaning and maintenance must not be performed by children without supervision.
- To guarantee the proper and safe functioning, should the device fall or impact violently, have it checked at an authorized customer service centre.
- Do not leave handkerchiefs or similar objects near the appliance.
- The power cord must never come into contact with the appliance.
- Always disconnect the appliance from the mains socket after use.
- Never insert or drop objects into the openings of the appliance.
- The appliance must not be used in environments where there is a high concentration of aerosol (spray) products or where oxygen is released.
- The hair dryer is equipped with an overheating protection device. In the event of overheating, the heating stops and only cold air is emitted. The heating will automatically switch on again after cooling.

GENERAL DESCRIPTION

Consult, depending on the model, figure [1] or [2].

Hair dryer with separate buttons for air flow [A] and temperature [B].

A – ON-OFF switch and air flow adjustment

B – Temperature adjustment button

C – Cold air shot button

D – Front grill

E – Removable filter

F – Cord strain relief

G – Power cord

H – Air concentrator

I – Air diffuser (if provided)

USE



This appliance is designed for professional use in commercial areas.

Connect the plug to the socket.

The hair dryer has 3 temperature levels and 2 air flow speeds, selectable via separate switches. If the appliance is fitted with cold air button [C], you can operate it for hairstyling.

Switch on the appliance using the On/Off switch [A] and select the required speed:

0 0 = OFF

▶ I = mid air flow

▶ II = strong air flow

Press the button to adjust the temperature [B] and select the level you prefer:

● I = low temperature

▶ II = mid temperature

▶ III = high temperature

After use, using the On/Off switch [A] to switch off the appliance.

Do not pull the cord or the appliance to disconnect the power cord [G] from the mains socket.

Store the appliance on a stable surface, paying attention not to wrap the cord around the appliance.

Cold air button (Cold Shot) [C]

If the appliance is fitted with this button, you can operate it for hairstyling.

Holding the cold air button pressed, the dryer can be switched quickly to operate with cold air and for hairstyling.

To return to the set temperature, simply release the button.

Using the air concentrator [H]

Thanks to the concentrator, the air is conveyed directly on the brush used for the hairstyle.

Apply the concentrator and press it in towards the body of the hair dryer (Fig. 3a).

The concentrator can be retrieved by pulling it in the direction indicated by the arrow b (Fig. 3b).



Wait until the nozzle has cooled down before removing it.

Using the air diffuser [I]

If the appliance has been equipped with the diffuser, this can be used to obtain a volumising drying.

Apply the diffuser and press it in towards the body of the hair dryer (Fig. 4a).

The concentrator can be retrieved by pulling it in the direction indicated by the arrow b (Fig. 4b).

MAINTENANCE



In case of malfunction or damage to the appliance or a part of it, the appliance must be analysed by the manufacturer or the relevant technical assistance or in any case by a person with similar skills in order to prevent any risk. The user must not disassemble the device him/herself.



Remove the plug from the mains socket before cleaning the appliance.

GENERAL CLEANING

Clean the appliance at least once a week.

To avoid all risk of electric shock, do not clean the appliance with water and do not dip it into water.

Only wipe the appliance with a soft cloth, dampened if necessary.

Do not use solvents or abrasive detergents!

FILTER CLEANING

To maintain optimum performance of the device over time, you should clean the filter regularly [E]:

- every day for intensive and continuous use

- twice a week for normal use
- once a month when used occasionally.

To do this proceed as follows:

1. Rotate the filter counter-clockwise (**Fig. 5a**) and remove it.
2. Rotate the filter grill where provided (**Fig. 5b**).
3. Clean the grill and the filter with a soft brush (**Fig. 5c**).
4. Reapply the grill to the filter and attach the filter to the frame of the appliance by turning it clockwise until full engagement (**Fig. 5a**).

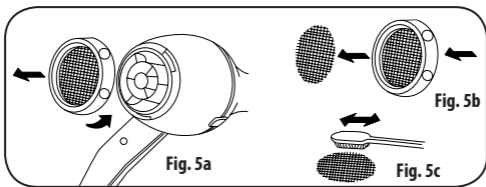

Do not use without the grill, hair can be sucked inside the product.

DISPOSAL



The product packaging is made of recyclable materials. Separate the parts according to their type and dispose of them in accordance with applicable laws on the environmental protection.



In accordance with the European Directive 2012/19/UE (WEEE), the unused appliance must be disposed of appropriately at the end of its life cycle. This concerns the recycling of useful parts of the appliance and allows a reduction in the environmental impact. For more information, please contact your local waste disposal facility or appliance retailer.

WARRANTY

The guarantee is valid under the current terms of law, it starts from the date of purchase and includes repair costs.

The warranty period is 1 or 2 years depending on the type of end consumer, according to European Directive 1999/44/EC.

The warranty is valid only upon presentation of the coupon with the rubber stamp and signature of the retailer and must indicate the date of purchase. Proof is the date shown on the receipt/invoice.

The warranty covers the quality defects of the appliance due to materials or its manufacturing. Gamma Più undertakes to repair or replace free of charge any parts that within the period of warranty may prove in its judgement not to be efficient due to material or manufacturing defects.

ATTENTION! The Warranty is void if on the appliance there are found to be direct interventions of the user or manipulation by unauthorized personnel.

THE WARRANTY DOES NOT COVER:

- Damage caused by non-compliant use, improper treatment or breakage during transport.
- Damage caused by non-compliance with the user instructions.
- Damage caused by use of the appliance with incorrect mains voltage.
- Appliances which mount accessories from other manufacturers.
- Parts subject to normal wear.

TECHNICAL SUPPORT

For repairs consult "Technical assistance centres (IT)" specified in this manual to contact the nearest centre and report the product model.

For an updated list of assistance centres visit the website:

www.gammapiu.it

The manufacturer reserves the right to make changes and/or replace parts at any time and without prior notice if it deems it appropriate in order to always offer a reliable and long-lasting product with advanced technology.



Gamma Più s.r.l.

Via Caduti del Lavoro, 22
25046 Cazzago S. Martino (BS) Italia
Tel. +39.030.77.50.207 - 77.50.077
Fax +39.030.72.54.999 - 77.50.206
info@gammapiu.it - www.gammapiu.it

